

DUCTAC

CENTREPOINT THEATRE TECHNICAL SPECIFICATION

Technical Manager: Anthony Manalo | a.manalo@ductac.org | +9714 3414 777 ext 334

Chief Technician: Philip Fortaleza | p.fortaleza@ductac.org | +9714 3414 777 ext 218

Jr Technician: Teodoro Estoce | t.estoce@ductac.org | +9714 3414 777 ext 329

DUCTAC, MALL OF THE EMIRATES, DUBAI, UAE, PO BOX 117748

UPDATED April 2017

Welcome to DUCTAC THEATRE – MALL OF THE EMIRATES

The team at DUCTAC are here to help your theatrical experience run as smoothly as it possibly can whether you are staging your performance in our main theatre CENTREPOINT or in our studio theatre KILACHAND we will help in every way to make sure your production is a success.

You may wish run an art, fitness or dance class in one of our many function rooms. Display your artwork in our spacious gallery, present a seminar or conference; the choice is limitless, whichever is your preference our staff will help you organise your event in whichever space suits your needs.

Certain spaces include basic technical equipment as part of your agreement, you may find this equipment adequate enough for your needs however should your event require additional extras we offer a range of lighting fixtures and accessories at very competitive rates so please take a look at our rate card on page 9. Please reserve any extra equipment in good time to ensure availability.

This summer we have upgraded much of our equipment with the latest technological advanced fixtures on the market in our efforts to keep abreast of the ever-changing demands and expectations of productions brought here from all over the world. We have also upgraded certain structural elements of the building with our on-going maintenance program, which is a constant challenge for our facilities team. One of the main upgrades this summer is the installation of a new Fire Safety Curtain in the main auditorium, which is in-keeping with Local, Federal Government and International Fire, H&S regulations.

As a result of this installation we request all of our existing clientele and future customers to read our compliance criteria on page 11. It is important that you become familiar with the form, which we ask you to complete, sign and return to the technical department no later than 21 days prior to the beginning of your tenancy. It can be scanned and emailed back for your convenience.

We do hope the changes we have made this summer will add to your DUCTAC experience and look forward to working with you over the new season and beyond.

We would appreciate any comments you have regarding all technical aspects of the venue and our staff will endeavour to answer any queries or questions to the best of their ability. We rely on your feedback to help us understand better the expectations of our clients and patrons alike thus enabling us to plan ahead for future changes and up-grades which will keep this venue operating at an international standard.

Thank you for taking your time to read the letter above.

Sincere regards from the technical team at DUCTAC.

Seating

Our main auditorium is tiered on two levels (Stall and Balcony) and has the capacity of 543. Provision is made for four-wheelchair usage. Our first two rows are removable to facilitate an orchestra pit. Also there are two VIP boxes (8 seats each) situated on both side of the balcony, two VIP boxes (8 seats each) at rear of stall next to both side of the technical control room.

Stage

Flat built timber covered sprung floor painted black with 12m x 7.2 m proscenium opening

Performing area: 12m W x 10m D x 15 m to the grid: 17.5m to grid I beams (RSJ)

Wing space: S.L. 3.2m W x 8 m D x 6 m H; S. R. 3.3m W x 9 m D x 6 m H

Proscenium arch safety curtain.

Communication

Stage Manager's desk is located at Stage Left with cast call paging system, cue light control and clear COM talkback system.

Six intercom lines with headsets can be installed at control box (2 points), SR, SL. Fly floor or Follow spot room.

Flying System

Fly floors are at 7m.

12 counterweighted bars (SWL 350 kg) stage left gallery.

5 motorized bars (SWL 350 kg) control panel DSL.

1 motorized bar with cyclorama/blacks (US).

4 hemp bars (SWL 350 kg) stage right gallery.

2 hand winched bars in wings (6x available lighting ladders)

10 3m Fixed bars for legs (Masking)

Masking and soft Hanging

1 set of red velvet house tabs (permanent attachment)

1 set of black mid-stage tabs (permanent attachment)

5 sets of black soft legs (3m x 8m - fixed)

1 White cyclorama (16m x 7m)

1 Black backdrop (16m x 8m)

1 Black gauze (16m x 8m)

Get-In / Access

All vehicles arriving must be less than **2.8m** high to park/unload on **level 2** (DUCTAC)

Loading platform is **0.75m** above driveway level with roller shutter door of **4m** wide / **6m** height

Larger vehicles can unload at **Loading Bay 10** (ground level) and use the large service lift to gain access to **level 2** (DUCTAC) loading level. Lift door size is 2.40m (7.87ft) x 2.40m (7.87 ft). Maximum lift load is 5000 kg.

There is an outer doorway, which has an aperture of only 2m sq, **(please take note of this for larger loads)**. If you require loading bay 10 please inform the technical department in good time so we can inform the Mall traffic management department prior to your arrival.

Ductac loading dock is Large and has easy access to stage with high scenic doors

Sound

Control located in room at rear of stalls

Main Console:

MIDAS Pro2 c digital console including 8 integrated mic/line inputs with MIDAS mic preamps, 64 simultaneous input processing channels, 8 VAC's, POP groups. For more information please visit www.midasconsoles.com

Sound System:

VQnet Software controls the main system. This is networked with VQnet enabled cabinets giving full control via a computer located in the control room, next to the main sound console.

All external amplifiers are Crown IT Series

Main System:

2x Tannoy VQnet 60.

2x Tannoy VQnet 218

Centre Cluster:

2x Turbosound TQ 315

Crown IT series amplifiers.

Front Fills:

4x Turbosound TCS-35

Crown IT series amplifiers.

Balcony:

3x Turbosound TCS-40

Crown IT series amplifiers.

On Stage Foldback/Monitoring:

4x Turbosound TFM 212 (Wedge)

2x Turbosound TQ 315 & 2x Turbosound TQ 425 (Side Fills)

Crown IT series amplifiers.

Note: *certain fixtures and accessories will be subjected to a daily rental charge. You will find the technical rate card on page 9 of this specification.*

Microphones:

4x Shure SLX Wireless 84 Lavalier/Lapel with belt pack
4x Shure SLX Wireless SM 58/Beta 58 Handheld
4x Countryman H6 Headset Microphone
4x Sennheiser EM 300 Receiver/SK 300 Bodypack
4x Sennheiser MKE1 Clip-on Microphone
2x Sennheiser E 914 High-Performance Condenser Instrument Microphone
2x Sennheiser E 614 Polarized Condenser Microphone
4x Sennheiser Meg 14-40 B Gooseneck
5x Shure SM58
6x Shure SM 57
4x Shure Beta 87A
2x Shure 81-LC
1x Shure Beta 52A
3 Crown PCC 160
2 DPA 4060 FM headset
2x DPA 4088-C
3x DPA 4088-F
8x DPA 4098-HB hanging mic
4x DPA 4099-D Drum
1x DPA 4099-P Piano
1x DPA 4099-G Acoustic guitar
1x DPA 4099-U Universal
16x K&M tall boom mic stands
Small stands, 4 Boom stands

In Ear Monitoring:

2x Shure PSM300 Personal Stereo Monitoring System with P3RA Pro Bodypack System
Available with SE215 Sound Isolating Earphones

Sound Consoles

1x MIDAS M32R – Digital Console for Live and Studio with 40 Input Channels. 16 MIDAS PRO Microphone Preamplifier and 25 Mix Buses.

1x Soundcraft EFX12 – 12 Mono + 2 Stereo Channel Analog Mixer with Built-in 24-bit Lexicon Effects

Stage Box

1x Midas Pro Series DL215 – 48 input, 16 output Stage Box with 48 MIDAS MIC Preamplifiers

2x Midas Pro Series DL153 – 16 input, 8 output Stage Box with 16 Midas Mic Preamplifiers

2x CAT5E – 100M Ruggedised Cat5e UTP Network Cables (100m Reel)

Outboard:

Yamaha SPX2000

1x KLARK TECHNIK parametric EQ

1x KLARK TECHNIK Compressor

6x KLARK TECHNIK 31 band EQ

Playback equipment:

1x Tascam CD 450 professional player

1x Tascam 350 mini disc recorder

2 Tascam 112MKII cassette recorders

Audio Recording:

A stereo mix from the console can be recorded in digital formats. Please note advance notice is required for set up.

Lighting

Control room at rear of stalls

Consoles:

ETC ION – 40 fader sub-master wing, itouch remote, fully networked, 2 DVI screens

Strand 300 Classic Palette – 250 channels, 24 sub-master, tracker, net worker, WYSIWIG

Martin M2GO – 4 DMX universes, 1000 cue lists, sub-master, groupmaster & override functionality.

Luminaries

Rama PC 15 ^o – 6 ^o	12	1200w 7 – 55
Rama PC 15 -6 Fresnel	17	1200w 5 – 60
Robert Juliant Fresnel	14	1200w
Pacific Profile	16	1200w 14 – 35
Altman Phoenix Ellipsoidal CE	14	750w 30-55
Par 64	12	1000w
Altman Par 64	24	1000w
Robe Spot 250 XT	8	250 W moving yoke lighting fixture
Martin MAC Aura	16	LED wash
Altman Spectra 200-Cyc	10	LED Cyc wash
Clay Paky Shadow ST	2	Follow Spot 1200 W full colour changing
Colour Scroller	14	15 Colour Scroller
Martin Atomic 3000	1	DMX Strobe Light 3000W

Blue LED fixtures are installed in the control room and in each wing for show working light' the stage has fluorescent strip lighting for working light during fit up's and get out's.

Note: *certain fixtures and accessories will be subjected to a daily rental charge. You will find the technical rate card on page 9 of this specification*

Accessories and Effects

2x Antari HZ 350

2x JEM ZR44 Hi Mass Smoke

1x JEM ZR33 Hi Mass Smoke

1 Martin Magnum Hazer Machine

15 steel deck stage units (Different size legs available)

Acrylic Lectern (Including goose neck microphone)

Harlequin Dance Floor (Black/Grey – full stage cover)

Projection

4x Christie LX41 Projector (4000 ANSI lumens)

2x Christie LX 605 Projector (6000 ANSI lumens)

PC Laptop / MacBook Pro

Resolution of projection = 1024 x 768

ONLY DVD, VHS or LAPTOP (VGA) formats will be accepted

Main stage projection screen (front projection) 4.5m / 6m

Power

Stage Left – 1x 32a single phase (sound only), 1x 63a three phase, 1x 16a single phase, 13a sockets (various)

Stage Right – 1x 32a single phase (sound only), 1x 63a three phase, 13a sockets (various)

Control Room – 13a sockets only (various)

Scene Dock – 3x 16a single phase, 3x 32a three phase, 13a sockets (various)

FOH – 13a sockets only (various)

Wardrobe:

Large room with 1x industrial washing machine, 1x industrial dryer, 10 costume rails.

Dressing rooms:

Total 7, all equipped with ablutions, can accommodate up to 104 performers

Show relay/cast paging.

Dressing Room Capacity

Below shows the Maximum capacity all Dressing rooms & Wardrobe.

Dressing Room 1, 2, 3 & 4	10 pax per room.
Dressing Room 5	15 pax.
Dressing Room 6	13 pax.
Dressing Room 7	5 pax.
Wardrobe	31 pax.

Please make sure to send all your lighting, sound, AV requirements plus schedules, set plans delivery movement etc. at least 2 weeks prior to your event so that we have adequate time to plan ahead. Your cooperation with this request is very much appreciated.

Note: certain fixtures and accessories will be subjected to a daily rental charge. You will find the technical rate card on page 9 of this specification

This Technical Specification will be up-dated on a regular basis and is subject to change and alteration. For the latest up-dated version please visit our website at www.ductac.org

Fixtures and Accessory Rate Card

Item	Daily cost per unit (AED)
Shure SLX wireless 84 Lavalier/ lapel + belt pack	200
Shure SLX wireless 58 & Beta 58 handheld	200
Sennheiser MKE1 wireless + belt pack	350
Sennheiser MEG 14-40 B Gooseneck	180
Shure SM 58 with stand	100
Shure SM 57 with stand	100
Shure BETA 87A	100
Shure SM 81-L	100
Shure BETA 52A	100
Crown PCC 160	80
DPA 4060 FM headset	150
DPA 4098-HB hanging mic	150
DPA 4099-C headset	150
DPA 4088-F headset	150
DPA 4098-HB hanging mic	150
DPA 4099-D Drum mic set	150
DPA 4099-P Piano stereo pair	150
DPA 4099-G Acoustic Guitar mic	150
DPA 4099-U Universal	150
Portable sound system	500
Audio recording single track	500
Audio recording multi track	1000
Robe spot 250 A.T (moving head)	350
Martin MAC Aura LED wash	450
Clay Paky Shadow ST (Follow spot) (Ductac operator could incur extra overtime charges)	450
JEM ZR 44 Hi Mass Smoke	300
JEM ZR33 HI Mass Smoke	300
Metro Deck riser plus legs	60
Harlequin Dance vinyl (full stage cover)	1000
Christie LX 605 - 6,000 lumens (inclusive of 4.5x6m screen)	1000
Christies LX 41 - 4,000 lumens (inclusive of screen)	500
PC Laptop / MacBook Pro	300
Acrylic or wooden Lectern	150
Prices are for units only and do not include operators	
Please make sure to reserve your rental requirements well in advance of your event to ensure availability of equipment	

Production Compliance Permit

Production Department			
Company Name:		Arrival date:	Departure date:
No of company members:	Male: <input type="checkbox"/>	Female: <input type="checkbox"/>	Children: <input type="checkbox"/>
Event Description:	Location:	Kilachand: <input type="checkbox"/>	Centrepoint: <input type="checkbox"/>

Safety Regulations whilst working on site.

Permissions and paperwork:

1. General work permission and any specialised permissions will only be granted after the following criteria and information submitted, has been checked by Ductac Technical & Facilities department heads.
2. All certification must be in English.
3. Contractor staff are required to provide relevant identification and valid work permits.
4. Show staff and contractors to show competency certification if using specialise equipment.
5. Permission to be requested if hot works are necessary on site.
6. A full risk assessment and method statement must be provided before work commences.
7. Combustible materials including scenery elements entering the theatre must have recognised (In Date) fire retardant certification. Machinery or material that have out **of date certification** will not be allowed on site.

Show/Contractor staff H&S:

1. All staff to be trained and certified on the safe use of equipment they will use on site.
2. Show and contractor personnel to be conversant with relevant H&S legislation and apply at all times.
3. Personnel must have enough job specific competence to be working in a theatre environment.
4. Working above 2m requires the use of a safety harness with lanyard to be fixed to an appropriate point.
5. If grid work is necessary the stage will become a hard-hat area.
6. Visiting personnel are expected to familiarise themselves the theatre evacuation procedures, fire routes and fire fighting appliances in their area of work.
7. Evacuation plans are posted on the back of all dressing room doors and can also be found posted in many other areas of the building.
8. Personal Protection Equipment (PPE) is to be used where necessary. Strictly no sandals to be worn while working.
9. The venue must remain tidy at all times, all-waste, building refuse and litter must be contained and will be removed daily.
10. Flight cases must be stored in an organised fashion throughout build-up – production – load-out periods.

Venue Capability:

1. The venue capabilities and restrictions should be fully understood by all visiting personnel.
2. Please make sure venue rental equipment's, permissions and facilities over and above your agreement have been detailed, obtained and reserved in plenty of time prior to your arrival.
3. Ductac will require 30 days notice of any livestock or vehicles intended to be used in a production. Permission will only be granted after agreement from the venue management and subject to all necessary valid permissions.

Electrical Equipment:

1. All portable electrical equipment supplied by a visiting company must have in-date PAT test certification.
2. Bare wires inserted into sockets will not be allowed.
3. Power distribution will be delivered by in-house technicians only.

Pyro/Strobe lighting/Flammable materials.

1. Permissions will be sought at corporate level for the use of the above elements and any intention for use must be supported by the relevant H&S certification, insurance and compliance with UAE police, civil defence and ministry guidelines. Ductac management would require 60 days notice of any such intention.
2. The use of Pyrotechnics will require a fully qualified technician to operate and oversee their deployment.

Personal Injury & Damage to Property.

1. Any injury sustained to visiting personnel or contractors as a result of their negligence or equipment defects will be the full liability of that person and not assumed by Ductac personnel.
2. Clients and contractors are required to have full liability insurance in place to provide cover for injury, death, building and equipment damage.
3. Any damage to Ductac property will result in repair or replacement with all costs charged to the violating company.
4. Ductac assumes no liability of services, transportation, personnel or equipment provided by the clients, contractors and sub-contractors.

We hereby agree to comply with all Ductac safety measures and procedures outlined during our tenancy and agree that no other work other than what has been agreed will be carried out during the tenancy. Ductac technical and facilities departments will be notified should there be any work not being able to be completed within the specified time slot.

It is the duty of the Client and Contractor to be familiar with the house Emergency Exits and Assembly points in your work area/zone. You are also responsible for understanding the Fire Evacuation procedure of the venue.

By signing this permit you agree that you will make yourself aware of the venue Fire and Evacuation procedures on your arrival at the venue.

An induction can be arranged for visiting companies and a Fire Evacuation plan can be emailed to you on request. Should you require any further clarification regarding these policies and procedures please do not hesitate to contact the venue.

Visiting Company Authorised Signatory	Print Name:
	Contact No:
Ductac Technical/Facilities Department Approval	Ductac Stamp
<hr style="width: 30%; margin: 0 auto;"/> Department Head	Date:
Remarks:	



LOADING BAY 10 MAP

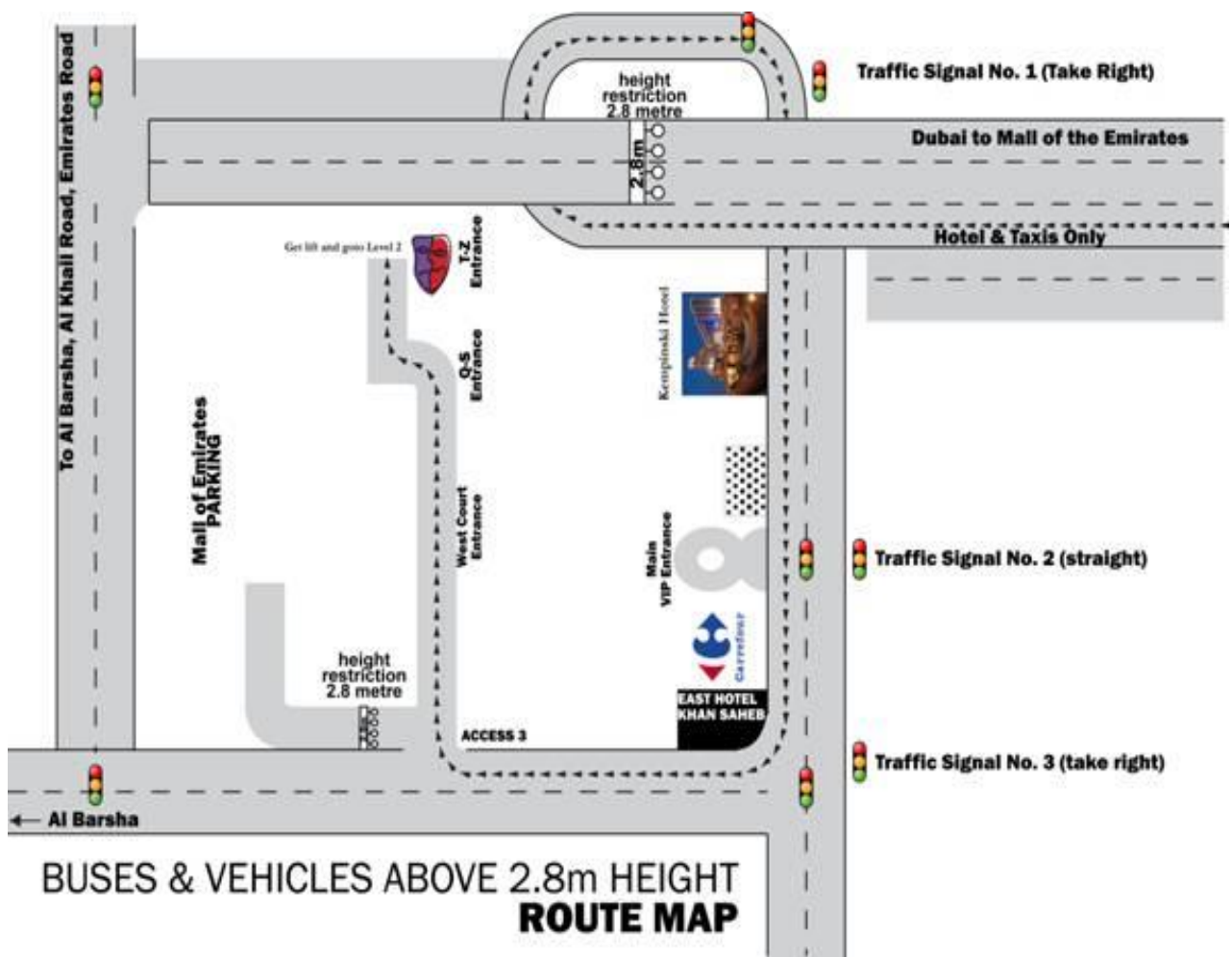

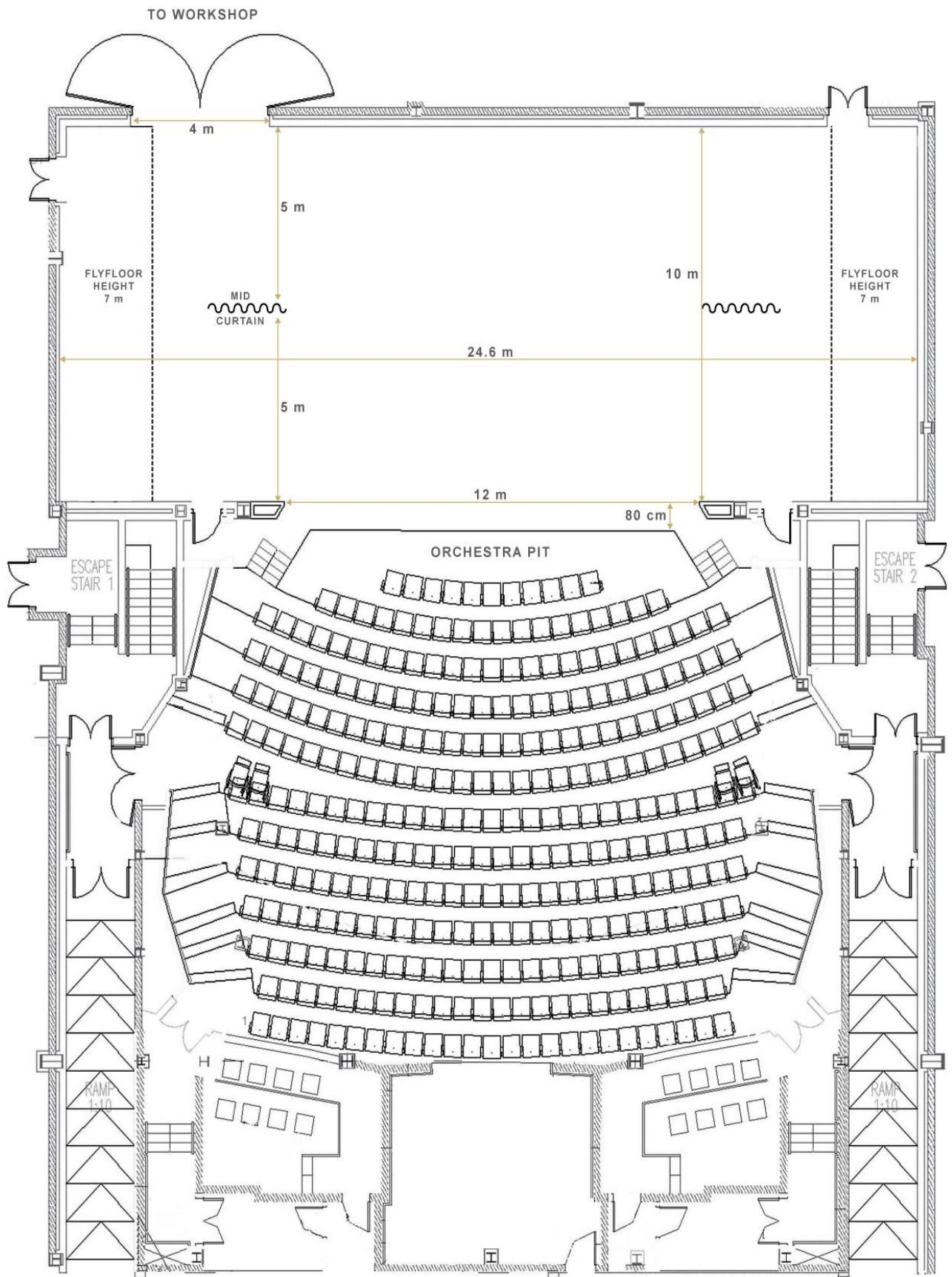

THEATRE DIMENSIONS

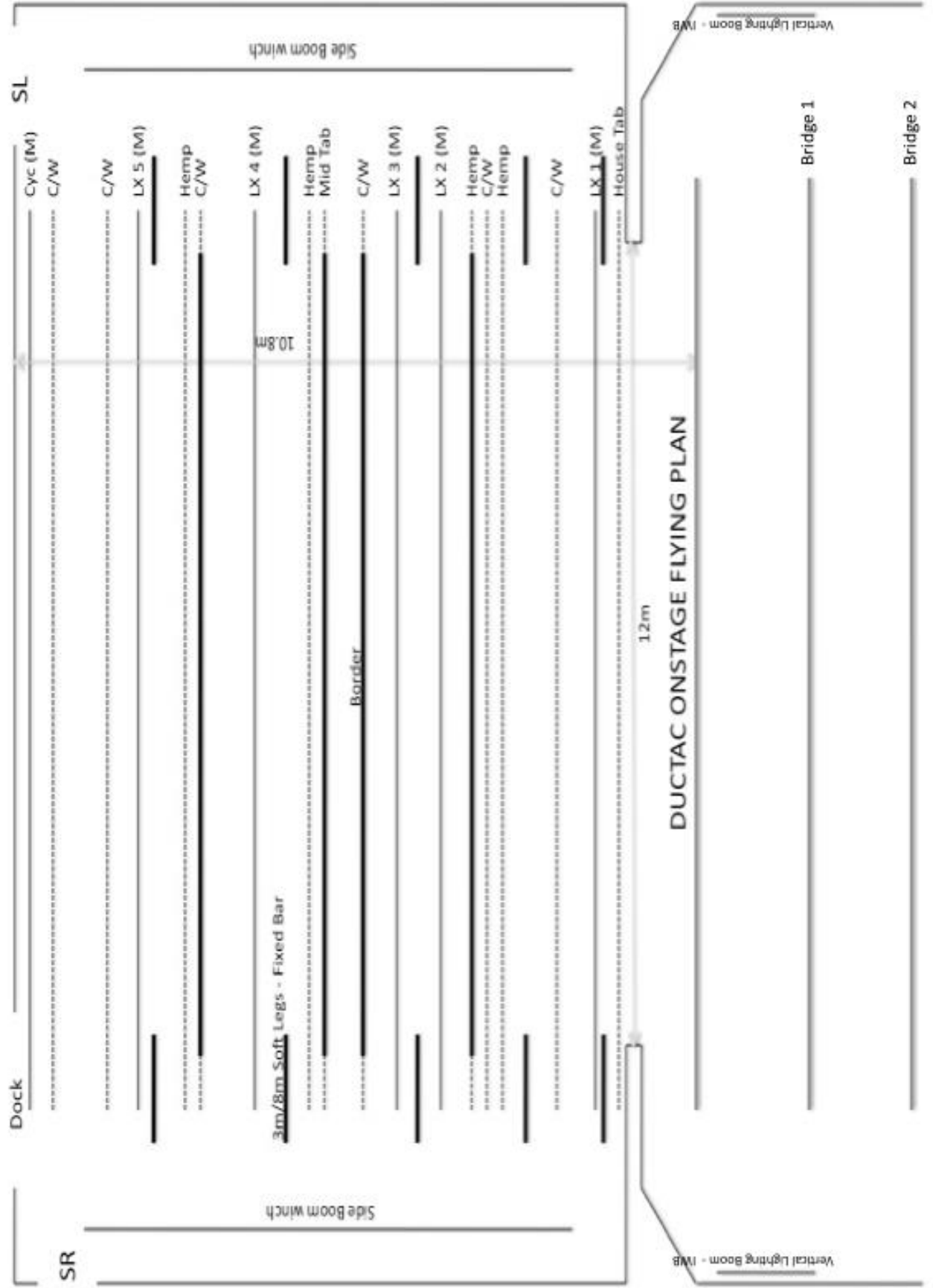

**Ductac FlyBar Distances from Plasterline
(Back of Proscenium)**

Bar ID	Type	Max SWL	Distance from prosc plasterline	Length of bar
MOTOR HOUSE CURTAIN	Fixed Bar	N/A	0.25	N/A
LX 1	Motor	350kgs	0.75	16m
Deadline	Masking Leg	N/A	1000	3m
C/W 1	Counter Weight	350kgs	1150	16m
C/W 2	Counter Weight	350kgs		16m
C/W 3	Counter Weight	350kgs	1950	16m
Deadline	Masking Leg	N/A	1900	N/A
H1	Hemp 1 B/B	350kgs	2000	16m
C/W 4	Counter Weight	350kgs	2350	16m
H2	Hemp 2 B/B	350kgs	2.65	16m
LX 2	Motor		3200	16m
Deadline	Masking Leg	350kgs	3400	16m
C/W 5	Counter Weight	350kgs	3550	16m
House Screen	Motor	350kgs	3900	16m
C/W 6	C/W B/B	350kgs	4300	16m
Deadlined Fixed Track	Midstage B/Tabs	N/A	4700	N/A
H3	Hemp Line 3	350kgs	5000	16m
Deadline	Masking Leg	350kgs	5100	16m
LX 3	Motor	350kgs	5500	16m
C/W 7 (Lx 4)	Counter Weight	350kgs	5900	16m
C/W 8	Counter Weight	350kgs	6350	16m
C/W 9	Counter Weight	350kgs	6750	16m
H4	Hemp 4 B/B	350kgs	7000	16m
Deadline	Masking Leg	350kgs	7100	N/A
LX 4a	Motor	350kgs	7500	16m
C/W 10	Counter Weight	350kgs	7550	16m
C/W 11	Counter Weight	350kgs	7950	16m
C/W 12	Counter Weight	350kgs	8750	16m
White Cyc	Motor	350kgs	9150	16m
BACK - WALL				
<u>OTHER</u>				
Wing Side Boom	Winch	250	N/A	
<u>Note:</u>	<i>From the front edge of the stage to the plasterline (back of the proscenium is .90cm</i>			
	Dubai Community Theatre & Arts Centre PO Box 117748 Dubai, United Arab			
PDF	Emirates www.ductac.org - Tel: +971 4 341 4777			PDF